



A3 Sheet-fed Duplex Scanner

High Scan Rate and Great Performance

Features:

- Scan rate up to 60 PPM/120 IPM at 300 dpi, color mode
- Scan rate up to 80 PPM/160 IPM at 300 dpi, B/W mode
- Support documents up to A3 size
- 118" (300 cm) long document scanning
- Support plastic cards scanning
- Ultrasonic multi-feed detection
- Professional bundled software includes Avison Button Manager, AvScan 5.0 ScanSoft PaperPort 11SE
- One button functionality allows you to assign up to nine scanning applications and select at the touch of a button

Avision's
Button Manager scans
directly to Adobe® certified
searchable PDF!



The Avison AV320E2+ is our most advanced and powerful high speed sheet fed document scanner. It is capable of scanning documents up to A3 sizes, ensuring a wide range of document compatibility at your workplace. Equipped with new and improved anti-skew rollers, it can take virtually any A8 to A3 size mixed documents you throw at it.

The most amazing aspect of the AV320E2+ is its incredible scanning speed – a lightning fast 60 ppm / 120 ipm at 300dpi resolution! Quantity and quality achieved, absolutely no compromises.

Ultrasonic Multi-Feed Detection

With the built-in ultrasonic multi-feed detection capability, the scanner allows you to set overlapped paper by detecting paper thickness between document. When multi-feed is detected a warning message will be prompted.

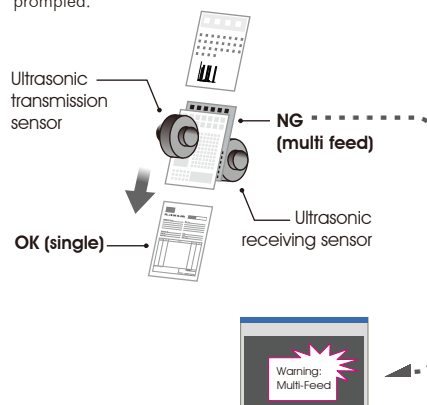

Long Document Scanning

The AV320E2+ provides you a convenient feature to scan long-page document up to 118" (300 cm). This is a cost and time-saving solution for insurance company and healthcare institutions that need to digitize insurance bills and patient's records.

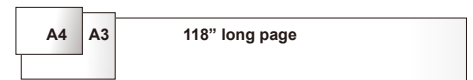

Intelligent Image Enhancement Tool

When the original documents are contaminated or damaged, containing marks, white fonts, etc., the intelligent image enhancement tool helps you create sharp and crisp image.

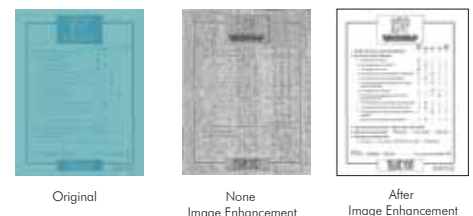

What we have bundled

The Avison AV320E2+ comes with TWAIN and ISIS drivers, and is bundled with Avison Button Manager, Avison AvScan 5.0, and ScanSoft PaperPort 11SE software application.

Avision AV320E2+ A3 Sheetfed Scanner

Avision's Button Manager

Complete your scan in a single step



The Button Manager main screen

Avision's state-of-the-art software application, the Button Manager, enables you to complete complex scanning task in just a single step. When the button is pressed, the scanner automatically scans your documents and converts them to a highly compressed file format, Adobe searchable PDF, or other image formats, and then sends the file to a designated folder, or other destination applications such as e-mail, printer, or your favorable software application. The original step-by-step procedure is replaced with only a single touch of the button.

AvScan 5.0

-The Intelligent Document Management Tool



The AvScan 5.0 main screen

Document Imaging is the very first step of Document Management. However, poor quality images can cause serious problems to later indexing or storing processes. It may increase scanning labour costs and lowers the OCR accuracy. AvScan 5.0 ensures all documents are checked and polished at the time they are scanned such that the image quality is guaranteed before they are ready to use for other purposes.

AvScan 5.0 is an intelligent scanning and electronic filing solution. AvScan 5.0 possesses distinct features that convert and index scanned information into electronic documents for easy storage and fast retrieval.



ScanSoft PaperPort 11SE

- The Professional Choice to Organize and Share Your Documents

PaperPort 11SE is the easiest way to turn piles of paper and photos into organized files that you can quickly find, use and share. Stop wasting time searching for paper documents. End the frustration of organizing, editing and sharing your digital photographs. PaperPort 11SE makes it simple to connect your scanner and computer together to work with PDF and JPEG images just like working with paper documents right on your desktop. It is the perfect solution for your home or small office. Save time and money with the security of knowing that important documents and photos will never be lost.

Avision AV320E2+ Product Specifications

Paper Feeding:	ADF 150-page capacity (60g/m ² or 16 lbs)
Scanning Technology:	Color Charged-Coupled Device (CCD)
Scanning Type:	Duplex
Document Size:	Max. 297 mm x 432 mm (11.7 in x 17 in) Min. 50 mm x 88 mm (2 in x 3 in)
Scanning Speed:	80 PPM/160 IPM (200 dpi, B/W) 60 PPM/120 IPM (300 dpi, color)
Paper Thickness:	28~413 g/m ² (7~110 lbs)
Long Page Mode:	118" (300 cm)
Optical Resolution	600 dpi
Output Resolution:	75, 100, 150, 200, 300, 400 and 600 dpi
Output Formats:	B/W, greyscale, 24-bit color
Bundled Software:	Avision AvScan 5.0 Avision Button Manager PaperPort 11SE
Interface/Drivers:	USB 2.0 / TWAIN/ISIS
Power Supply:	Input: 100~240 VAC, 50/60 Hz Output: 24V, 2A
Power Consumption:	<68 W
Environmental Factors:	Operating temperature: 10°C to 35°C (50°F to 95°F) Operating humidity: 10% to 85%
Acoustical Noise:	Standby: <45 dB Operating: <58 dB
Dimensions(W x D x H):	420 mm x 216 mm x 250 mm (16.5 in x 8.5 in x 9.8 in)
Weight:	12 kg (26.4 lbs)
Recommended Daily Scanning Volume:	Up to 8,000 pages
Multi-feed Detection:	Ultrasonic

System Requirements

- Pentium 4 or higher
- Windows®XP/2000/Vista/7
- 256MB RAM for Windows XP
- CD-ROM drive
- USB port

Contents

- AV320E2+ Scanner
- Power Supply
- Quick Guide
- USB 2.0 Cable
- CD-ROM includes:
 - Scanner Driver (TWAIN/ISIS Driver)
 - Avision Button Manager
 - Avision AvScan 5.0
 - ScanSoft PaperPort 11SE

Avision

www.avision.com

Avision Inc.

No. 20, Creation Rd. I
Hsinchu Science Park 30077, Taiwan,
R.O.C.

Tel: 886-3-5782388
Fax: 886-3-5777017

E-mail: sales@avision.com.tw

Avision Europe GmbH

Bischofstr. 101
47809 Krefeld
Germany

Tel: +49-2151-15759-0
Fax: +49-2151-56981-42

E-mail: info@avision-europe.com

